

DIP Switch Settings



| 핀 번호 | ON(▼) | OFF(▲) |
|------|--------------------------------------|---|
| 1 | HDMI Mode | Skip HDMI Mode |
| 2 | Navigation Mode | Skip Navigation Mode |
| 3 | External Rear View Camera | Original Rear View Mode (OEM CAMERA) |
| 4 | External Front View Camera(AV1 Mode) | Skip External Front View Camera(AV1 Mode) |
| 5 | AV2(DVBT) Mode | Skip AV2(DVBT) Mode |
| 6 | Not Used (default OFF) | |
| 7 | Select car model | |
| 8 | | |
| 9 | | |
| 10 | | |

| No.7 | No.8 | No.9 | No.10 | Car Model |
|--------|--------|--------|--------|--------------------------------|
| OFF: ▲ | OFF: ▲ | OFF: ▲ | OFF: ▲ | 2019 ~ ES300h 2019 ~ NX300h |
| OFF: ▲ | OFF: ▲ | OFF: ▲ | ON: ▼ | 2019~ UX 7inch |

Activation by
original buttons



Lexus UX 7inch

Please cutting the wire.
If not cutting. The interface screen will be blinked

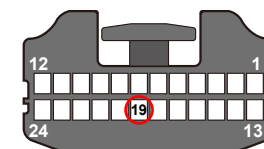

Pin# = 19 Light Brown

The screen over 10inch does not need to cutting.

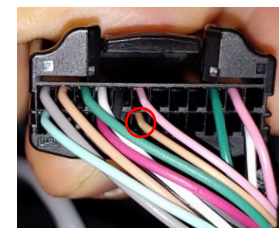

Head Unit Main Connector

※ The OEM wire color may different. Please. checking with PIN number

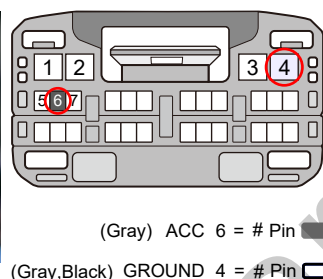
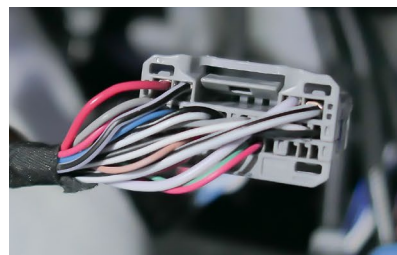

Head Unit Main Connector

※ The OEM wire color may different. Please. checking with PIN number

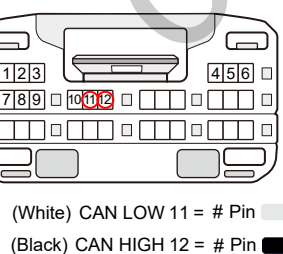
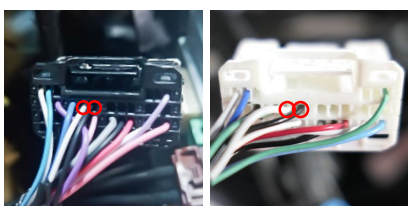

2019 NX300h
support@car-solutions.com

2019 ES300h

| Buttons | Function | Operation | Remarks |
|---------------|-----------------------|----------------------------------|-------------------------------------|
| 1 MAP | Changing Modes | Press the button 2 seconds long. | Order : OEM → HDMI → NAVI → NAVI |
| 2 BACK | Changing Modes | Press the button 2 seconds long. | Order : OEM, HDMI ,NAVI → NAVI |
| 3 ▲ Button | Changing screen ratio | Press the button 2 seconds long. | Fit Size & Full Size |

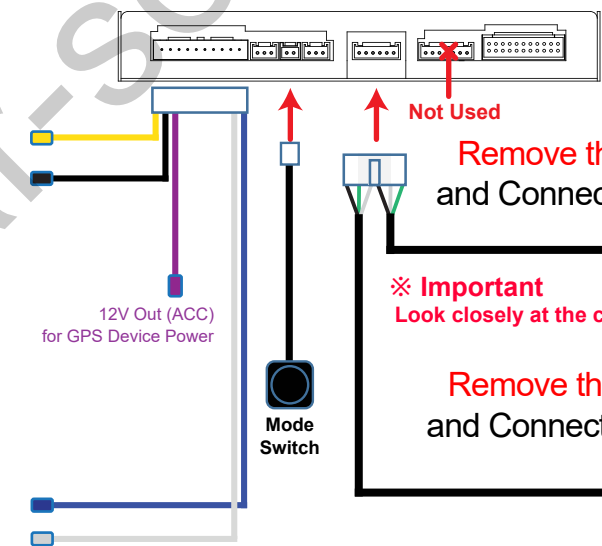

Monitor Main Connector

Please cutting the wire. for installation Around view camera
If not cutting. The interface can not change screen to
"External rear camera,AV1"

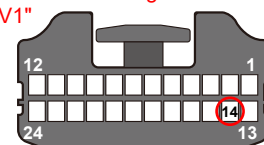

Pin# = 14 Reverse Detect (Pink)

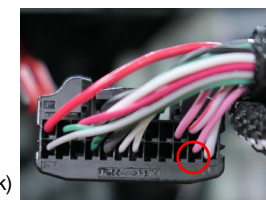

OEM Screen



Remove the OEM GVIF cable
and Connect Provied GVIF cable

※ Important
Look closely at the cable for correct IN / OUT

Remove the OEM GVIF cable
and Connect Provied GVIF cable

OEM Head Unit

