

Volvo SENSUS S60L XC60 V40 Rearview Interface Installation Guide

Wiring diagram:

Note:

Please turn ignition OFF before installing the interface.

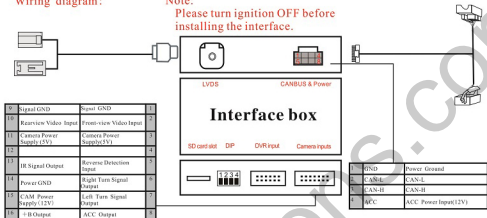

Volvo SENSUS S60L XC60 V40 Rearview Interface Installation Guide

Model: RS-6112

Notice:

1. Keep flameout & unplug car key before installation
2. Please make sure this interface matches with your car model



1. Use trim removal kits to take out of main unit (Position depends on car models)



2. Take out of Climate controller panel.



3. Get out of car main unit.



4. Unplug Blue video connector at the rear of main unit. Plug & Play to Interface connector.



5. 40 way Quadlock connector on the back of main unit



6. Unplug original 40 way quadlock connector, and connect it to Interface corresponding connector. Connect the original connector to its original place.

support@car-solutions.com

car-solutions.com