

Installation Manual

Q-ROI AUDI Q7 / A4

Warning / Precautions!



Warning

- Do not modify, dismantle or unintended operation this system outside Q-roi After Sales. Damage occurred by unintended operation may cause Q-roi After Sales service void.



Warning

- Always wear seatbelt. When the vehicle is suddenly stop can cause injury.
- Remove dust, oil, and waste on the display.
- Incidental damages (including, without limitation, consequential damages due to the use of this unit and the dead loss of business profit, changes, loss of memory contents, etc) will not be taken responsibility.
- Any function that requires your prolonged attention should only be performed after coming to a complete stop. Always stop the vehicle in a safe location before performing these functions. Failure to do so may result in an accident.
- The engine is off while the system operates for long time, battery may be discharged.
- This product is not a substitute for your personal judgment. Any route suggested by this navigation system may never supersede any local traffic regulation. Do not follow route suggestions if the navigation system instructs you to perform an unsafe or illegal maneuver.

1. General Spec

OS	Android 4.2.2 (Jelly Bean)
CPU	Telechips TCC8930 (1GHz Cortex A9 DualCore)
Display	OEM LCD
Internal Memory	DDR3 1GB RAM + 8GB eMMC
External Memory	SDHC Slot Support (up to 64GB)
Function	A/V Input x 3, Rear Cam Input x 1, CAN(Controller Area Network) x 2, Mic x 1, External Speaker x 1 (mono), External Audio Out x 1(Car Aux),
Output	LVDS (thru Video Interface), RGB (thru Sub-Board)
Touch Type	Resistive Touch
GPS	SiRF
Resolution	800*480
USB	USB 2.0 x 5 (USB x 4, OTG USB x 1)
Input Voltage	12V
Temperature	operating 0 C to 60 C
	Storage -20 C to 60 C
Languages	multi-languages

2. System Diagram

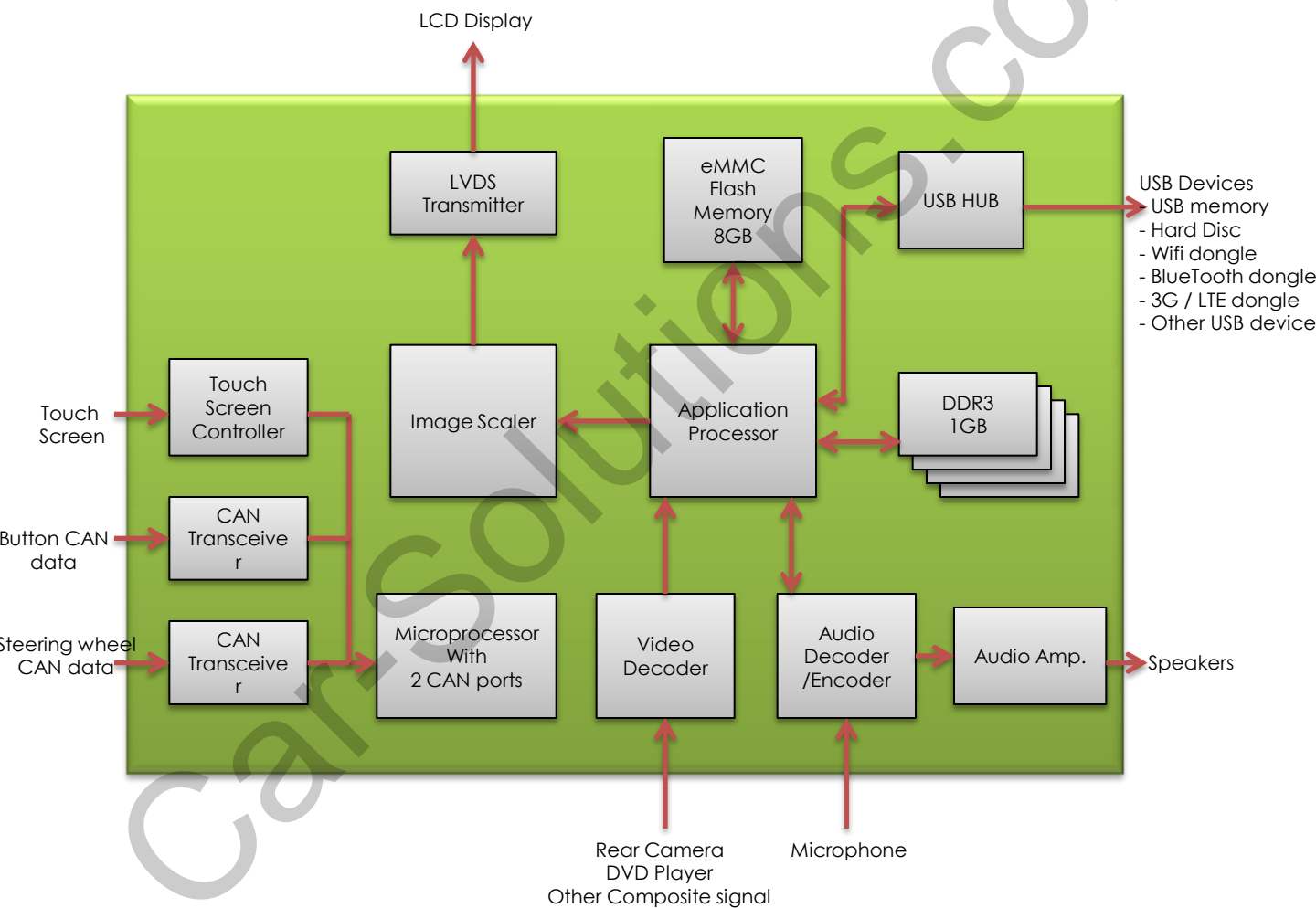

3. Components



LCD cable * 2ea
(HLCDCA0033)



SD Extension Cable * 1ea
(HARETC0080)



USB cable * 2ea
(HARETC0078)



3G dongle * 1ea
(ETCETC0116)



WIFI dongle * 1ea(Option)
(ETCETC0110)



Power cable 16P * 1ea
(HPOWER0103)

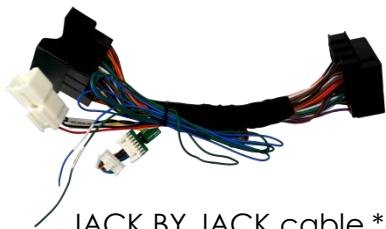

JACK BY JACK cable * 1ea
(HPOWER0102)



LVDS cable* 1ea
(HLVDSC0032)



LVDS cable* 1ea
Sub to Sub
(HLVDSC0028)

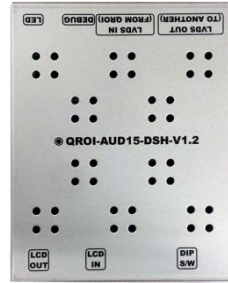

DSH sub-board * 1ea
(QCPASS0701)

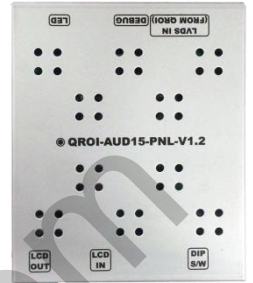

PNL sub-board * 1ea
(QCPASS0700)



TOUCH cable * 1ea
(HTOUCH0007)



GPS Antenna * 1ea
(GPSANT0009)



MODE switch cable* 1ea
(HARETC0001)



Multi cable * 1ea
(HARETC0068)



Speaker * 1ea
(SPEAKE0007)



AV/BT Cable * 1ea
(HAVCAB0020)



Microphone cable * 1ea
(MICPHO0001)



REAR CAMERA cable * 1ea
(HARETC0002)

4. OEM Buttons (Q7)

※ Steering wheel



Long press : Q-ROI Screen
Short press : OEM Screen

※ MMI

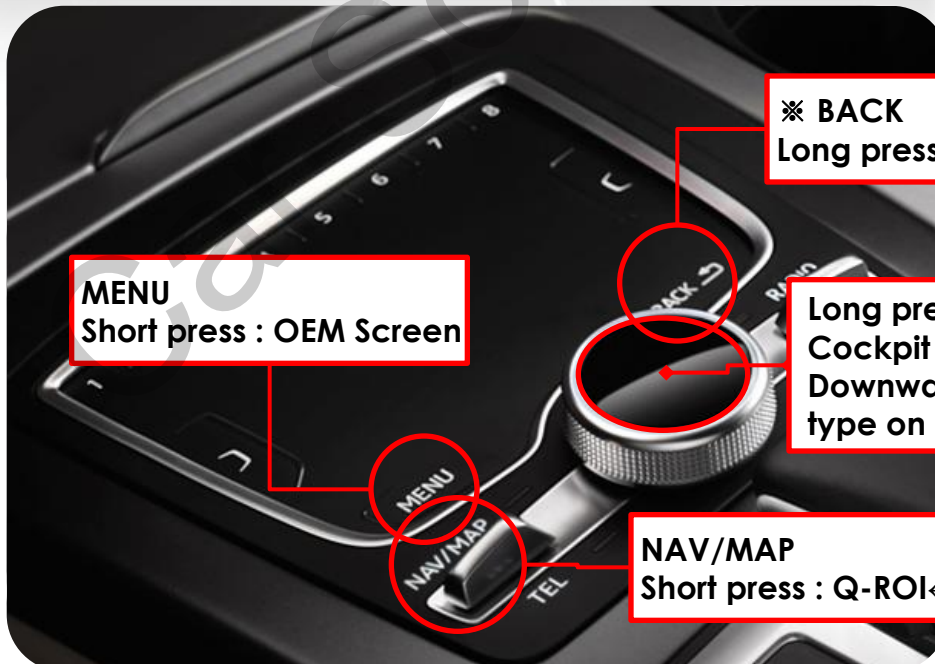

MENU
Short press : OEM Screen

※ **BACK**
Long press : Q-ROI↔OEM Switch

Long press : change size of
Cockpit screen
Downward : change PDC
type on Rear Camera Screen

NAV/MAP
Short press : Q-ROI↔OEM Switch

4. OEM Buttons (A4)

※ Steering wheel



Long press : Q-ROI Screen
Short press : OEM Screen

※ MMI

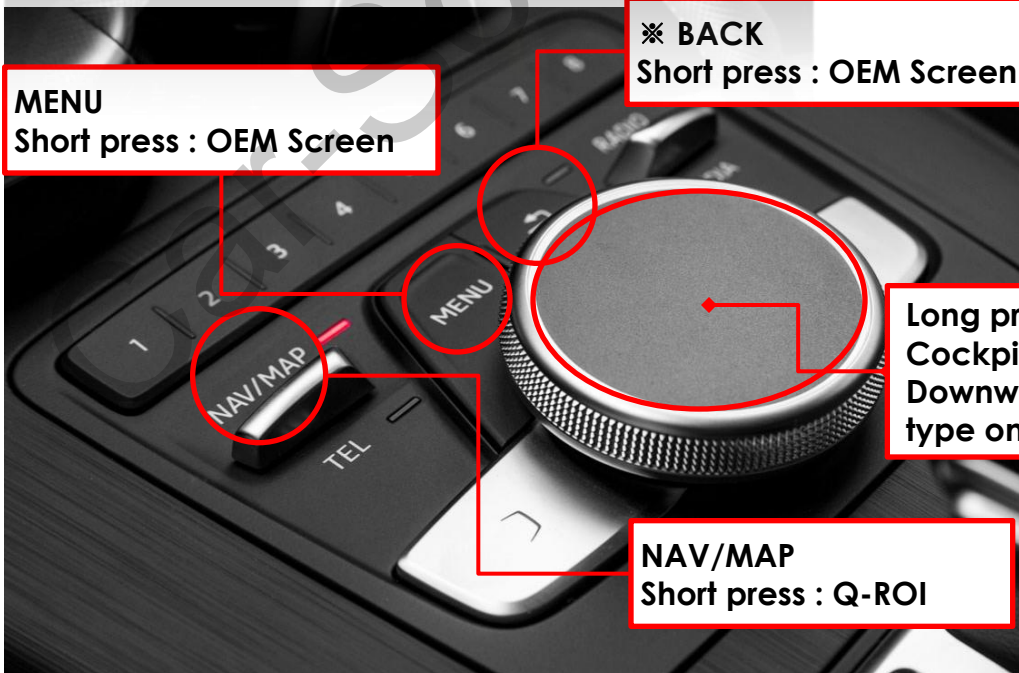

MENU
Short press : OEM Screen

※ BACK
Short press : OEM Screen

Long press : change size of
Cockpit screen
Downward : change PDC
type on Rear Camera Screen

NAV/MAP
Short press : Q-ROI

5. Cautions before installation

- Ignition key should be taken off before starting installation, interface power connection must be the last step in installation.
- Power cable should be separated when connecting interface.
- Should be no any electronic devices or magnetic pole around installation place.
- All steps of installation should be done by well-trained specialist.
- Dismantling without manufacturer's permission can not be guaranteed, (No permission to break attached label on the board.)
- Kindly check all parts are in the box, when receiving the product, if anything missing, inform to the supplier or manufacturer.
- Install GPS away from electromagnetic devices such as black boxes, Hi-Pass and etc.
- Advisable to Install GPS at the edge of dash board or a front window or a rear window.
- Install GPS antenna mounted on window or roof facing to Sky.
- According to our sales policy, any problems caused by user's mistake, careless can not be guaranteed.

6. Installation

6.1 Dip Switch Setting(MAIN BOARD)



PIN	Function	Dip S/W
1,2,3	No use (OFF)	
4	Bluetooth Pop-up function	OFF : Bluetooth Pop-up use ON : Bluetooth Pop-up no use
5	Car model	5-ON, 6-OFF : Q7 5-OFF, 6-OFF : A4
6		
7	Rear view camera	OFF : OEM RVC ON : External RVC
8	No use (OFF)	

※ PNL SUB-BOARD



PIN	Function	Dip S/W
1, 2	Car model	1-OFF, 2-OFF : Q7 1-OFF, 2-OFF : A4
3,4	No use (OFF)	

※ DSH SUB-BOARD



PIN	Function	Dip S/W
1, 2	Car model	1-OFF, 2-OFF : Q7 1-ON, 2ON : A4
3,4	No use (OFF)	

※ Please make sure to disconnect the power cable of the interface and reconnect the power cable again to apply the dip switch setting whenever changing DIP switch. Otherwise, DIP switch setting will not be applied.

6. Installation

6.2 Setting Factory Menu

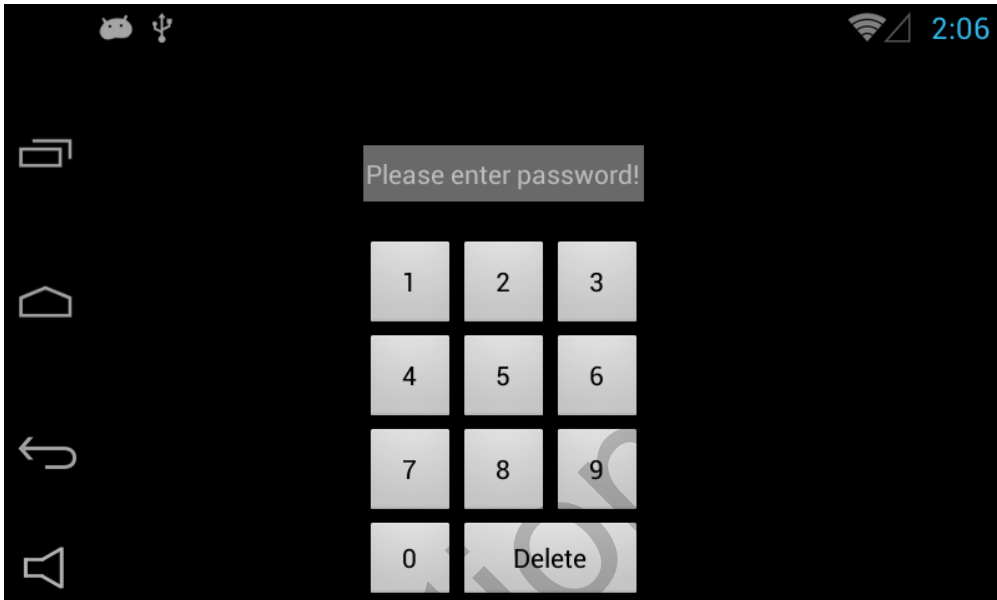

※ APPS→FACTORY SETTING

① Put Password and change program upgrade and set-up of external device. (Only Installers are authorized)

※ Please contact the manufacturer to get Password.

6. Installation

6.2 Setting Factory Menu

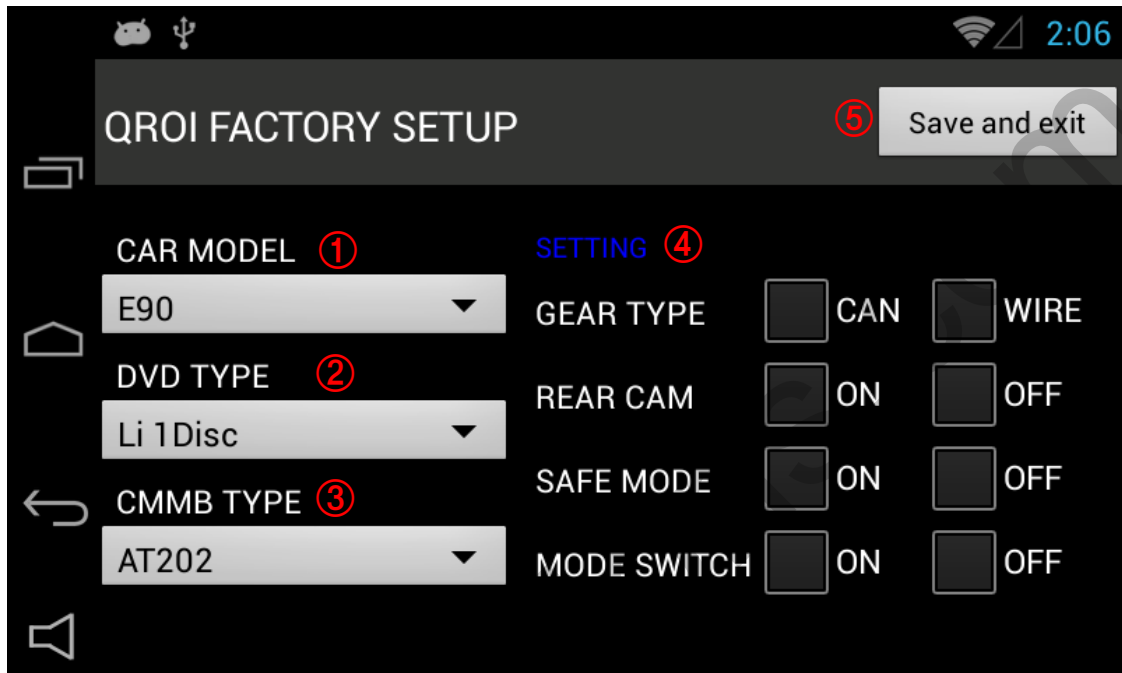

① CAR MODEL : **NO use**

② DVD TYPE : Only for DVD connected to A/V

(Connect IR-AV1 to DVD to use DVD as touch Screen)

③ CMMB SELECT : Select DTV model (Only Chinese)

④ SETTING

- GEAR CHECK TYPE : Detecting rear camera via either CAN or Rear Lamp.

- REAR CAM : Put "On" – External rear camera

Put "Off " – OEM Camera

- SAFE MODE : Either Enable or Unable to watch Video while driving

- MODE SWITCH : **NO use**

⑤ SAVE & EXIT : Save and Reboot

6. Installation

6.3 Installation diagram

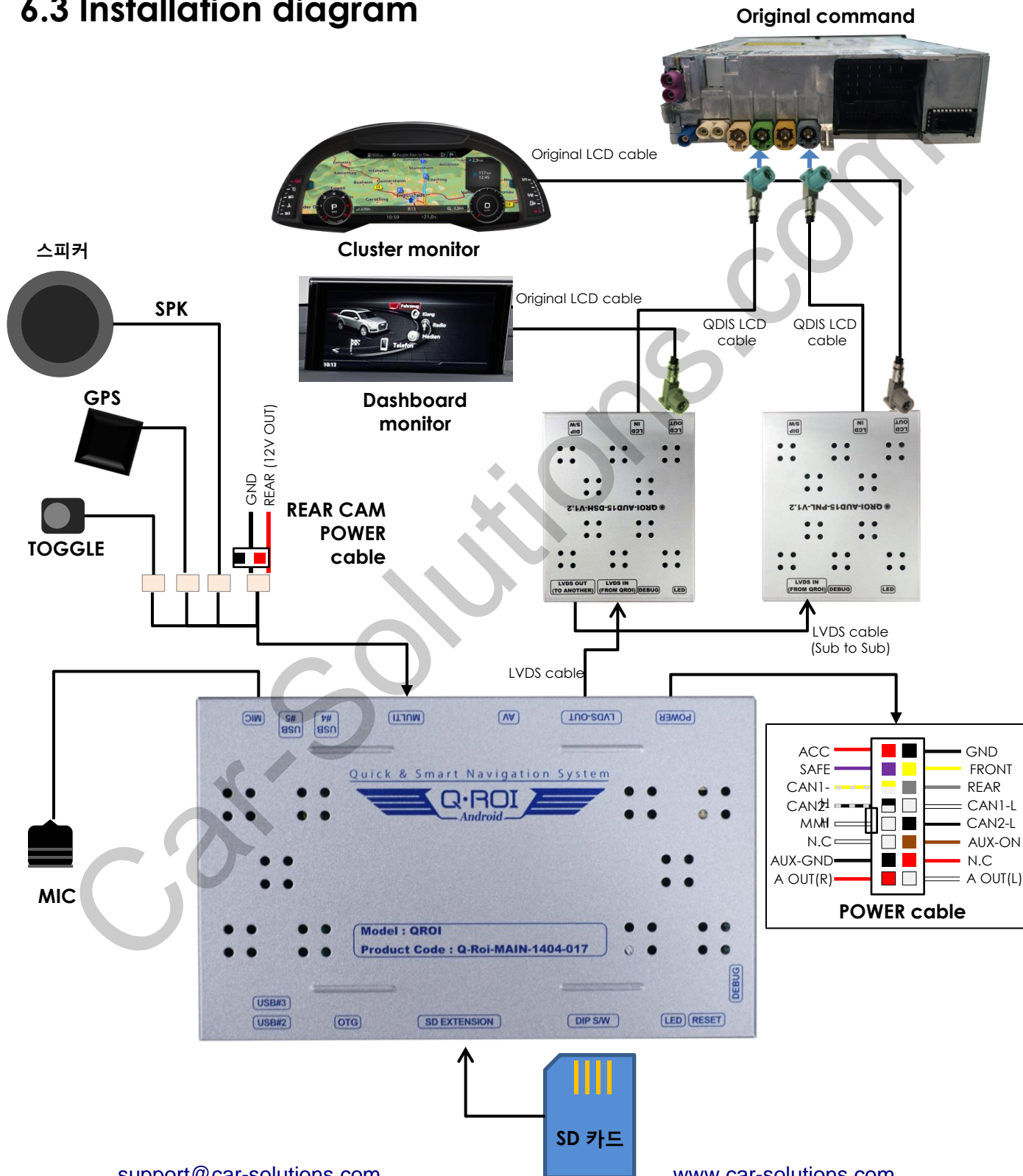

6. Installation

6.4 Power cable connection

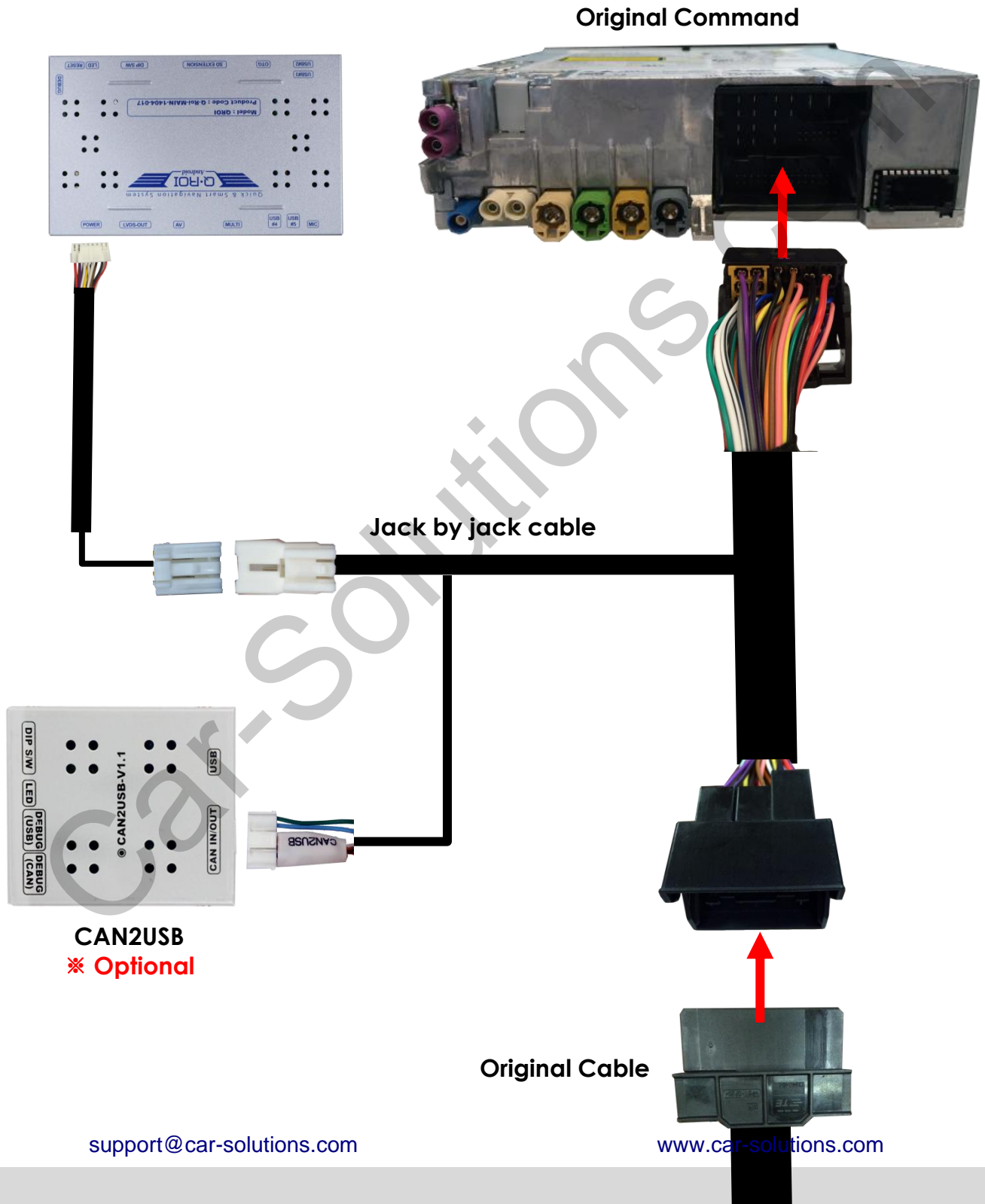

7. Quality warranty

This product has been tested and have passed under our strict quality control. If the failure occurred due to the carelessness of workmanship within one year after the purchase, we are responsible to repair free of charge.

Please bring this warranty to dealer whom you purchased this product from at the repair time. Should this warranty not presented, repair charged will be on customer. Please keep this warranty card.

Warranty			
Product name	QROI		
Warranty period	1 year	Purchase date (yy/mm/dd)	
Customer	Address		
	TEL		
	Name		
Dealer	Address		
	Name		

Memo

Car-Solutions.com

Memo

Car-Solutions.com