

Connecting REV reverse signal activation wire

In some cases, when the car was not equipped with a rear view camera, reverse activation signal may be absent from the head unit wiring. For case like these we have included a gray **REV** wire in the package contents. This wire should be connected, as shown below, and powered up with +12 V, which appear when the car is switched to reverse. For example, it can be connected to a rear lamp contact, where +12 V appears. Activation signal connection can be checked in the diagnostics menu of the car radio. The cable is shown below.



Reverse signal activation wire.

Let's demonstrate **REV** wire connection in NB1 car radio. This activation wire should be in the main power connector, highlighted in blue on the picture below.

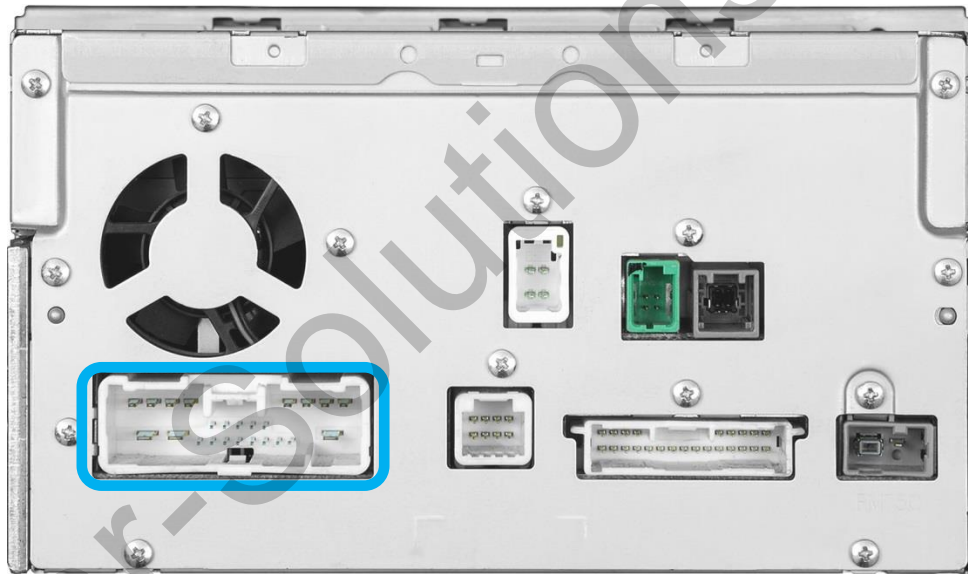

Mazda NB1 head unit, EU version with navigation connection option.

REV activation wire, if it's not present in the OEM wiring, should be connected in the OEM connector, namely, to the pin, highlighted in red.

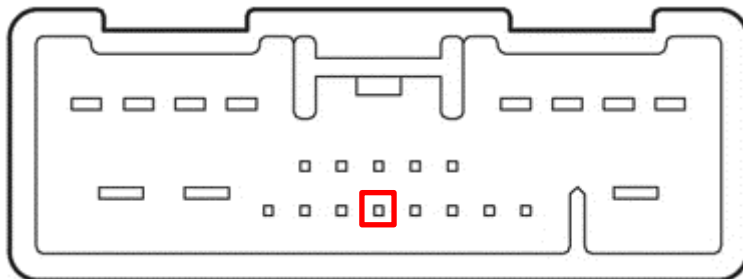

REV wire should be connected here.

To connect the **REV** activation wire, do the following:

1. Disconnect the wire (shown below) from the head unit.

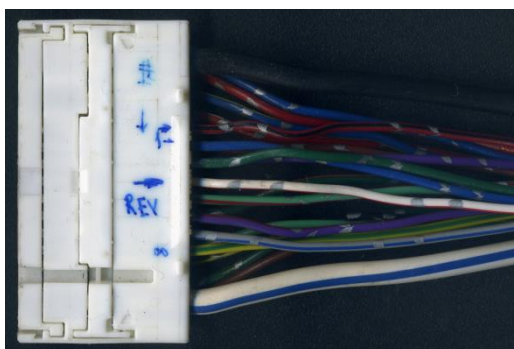

OEM connector with wires.

2. Lift up the fixator (*highlighted in pink*) in the notches that arrows point to. The fixator should move out about 1 mm.

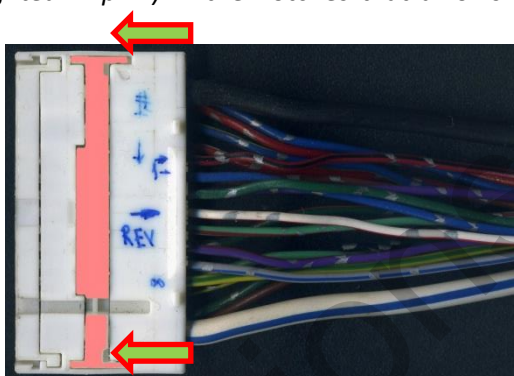

Fixator (*highlighted in pink*).

3. Prepare the **REV** activation wire for connection to the OEM connector.



4. Connect the **REV** activation cable to the OEM connector, as shown below.



5. Close the fixator.

