

Q-Roi Audi(H)

Instruction Manual

Index

1. General spec
2. System Diagram
3. Components
4. Setting up Dip S/W
5. Setting up FACTORY MENU
6. Cautions before Installation
7. Installation Diagram
8. Installation
9. Quality Warranty

Warning / Precautions!



Warning

- Do not modify, dismantle or unintended operation this system outside Q-roi After Sales. Damage occurred by unintended operation may cause Q-roi After Sales service void.



Warning

- Always wear seatbelt. When the vehicle is suddenly stop can cause injury.
- Remove dust, oil, and waste on the display.
- Incidental damages (including, without limitation, consequential damages due to the use of this unit and the dead loss of business profit, changes, loss of memory contents, etc) will not be taken responsibility.
- Any function that requires your prolonged attention should only be performed after coming to a complete stop. Always stop the vehicle in a safe location before performing these functions. Failure to do so may result in an accident.
- The engine is off while the system operates for long time, battery may be discharged.
- This product is not a substitute for your personal judgment. Any route suggested by this navigation system may never supersede any local traffic regulation. Do not follow route suggestions if the navigation system instructs you to perform an unsafe or illegal maneuver.

1. General Spec

OS	Android 4.2.2 (Jelly Bean)
CPU	Telechips TCC8930 (1GHz Cortex A9 DualCore)
Display	OEM LCD
Internal Memory	DDR3 1GB RAM + 8GB eMMC
External Memory	SDHC Slot Support (up to 64GB)
Function	A/V Input x 3, Rear Cam Input x 1, CAN(Controller Area Network) x 2, Mic x 1, External Speaker x 1 (mono), External Audio Out x 1(Car Aux),
Output	LVDS (thru Video Interface), RGB (thru Sub-Board)
Touch Type	Resistive Touch
GPS	SiRF
Resolution	800*480 or 1024*480
USB	USB 2.0 x 5 (USB x 4, OTG USB x 1)
Input Voltage	12V
Temperature	operating 0 C to 60 C
	Storage -20 C to 60 C
Languages	multi-languages

2. System Diagram

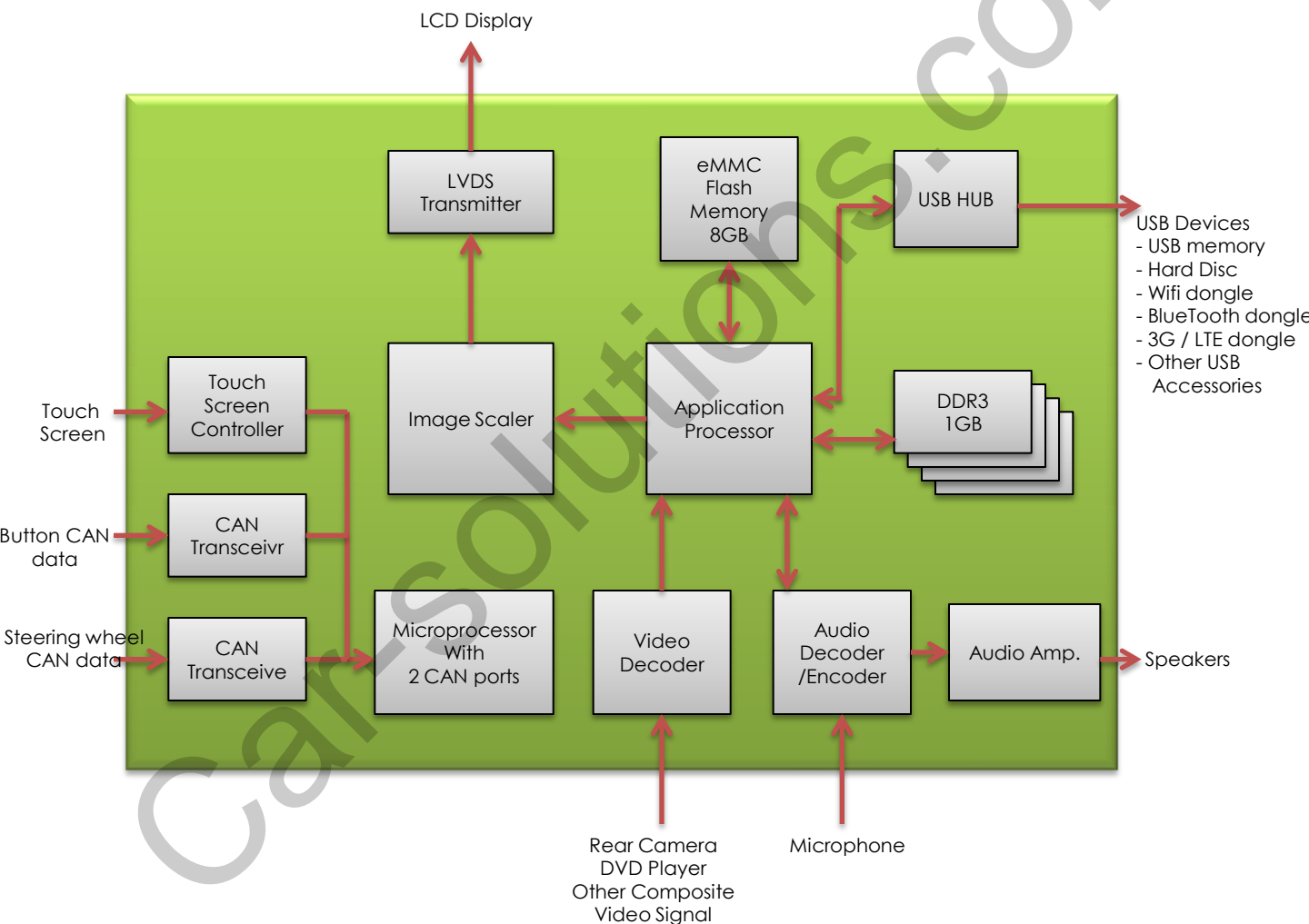

3. Components



LVDS cable* 1ea
(HALVDSC0024)



LCD cable * 1ea
(HLCDCA0015)



3G dongle * 1ea(Option)
(ETCETC0116)

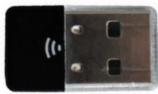

WIFI dongle * 1ea(Option)
(ETCETC0110)



TOUCH cable * 1ea
(HTOUCH0007)



Power cable 16P * 1ea
(HPOWER0041)



Multi cable * 1ea
(HARETC0068)



AV/BT Cable * 1ea
(HAVCAB0020)



USB cable * 2ea
(HARETC0027)



GPS Antenna * 1ea
(GPSANT0006)



MODE switch cable* 1ea
(HARETC0001)



Speaker * 1ea
(SPEAKE0001)



Microphone cable * 1ea
(MICPHO0001)



REAR CAMERA cable * 1ea
(HARETC0002)

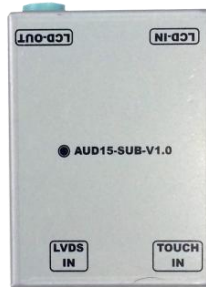

AUDI15 sub-board * 1ea
(QCPASS0594)



Sub-board * 1ea
(QCPASS0482)



4. Setting up Dip Switch(Main board)

※ ON : DOWN / OFF : UP



: A6, A7, A8 High Resolution Monitor (8inch)



: A6, A7, A8 Low Resolution Monitor (5.8inch)



: A6, A7, A8 2015year (Use AUDI15 sub-board)

※ Please make sure to disconnect the power cable of the interface and reconnect the power cable again to apply the dip switch setting whenever changing DIP switch. Otherwise, DIP switch setting will not be applied.

5. Setting Factory Menu

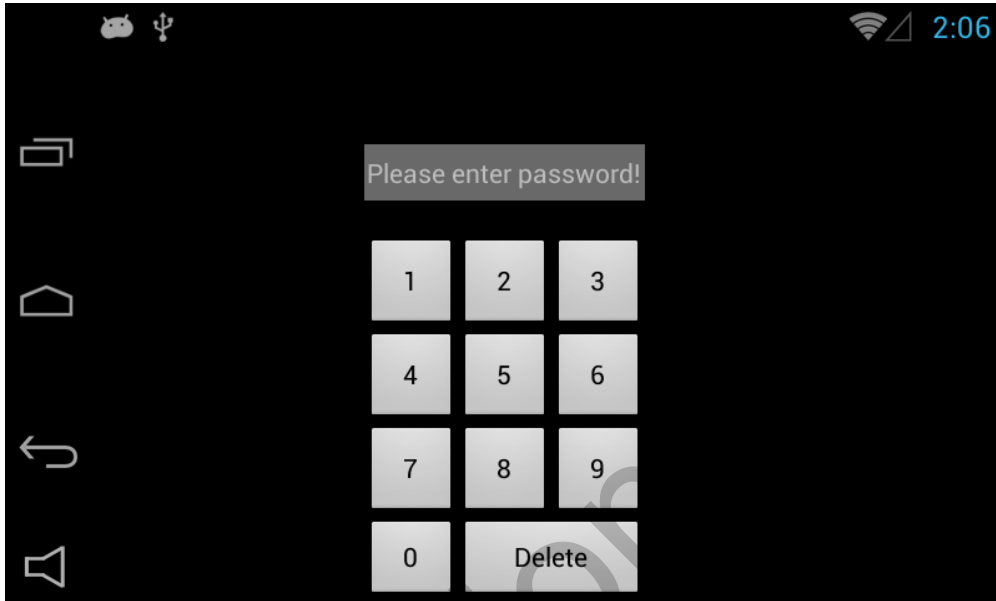

※ APPS→FACTORY SETTING

① Put Password and change program upgrade and set-up of external device. (Only Installers are authorized)

※ Please contact the manufacturer to get Password.

5. Setting up Factory Menu

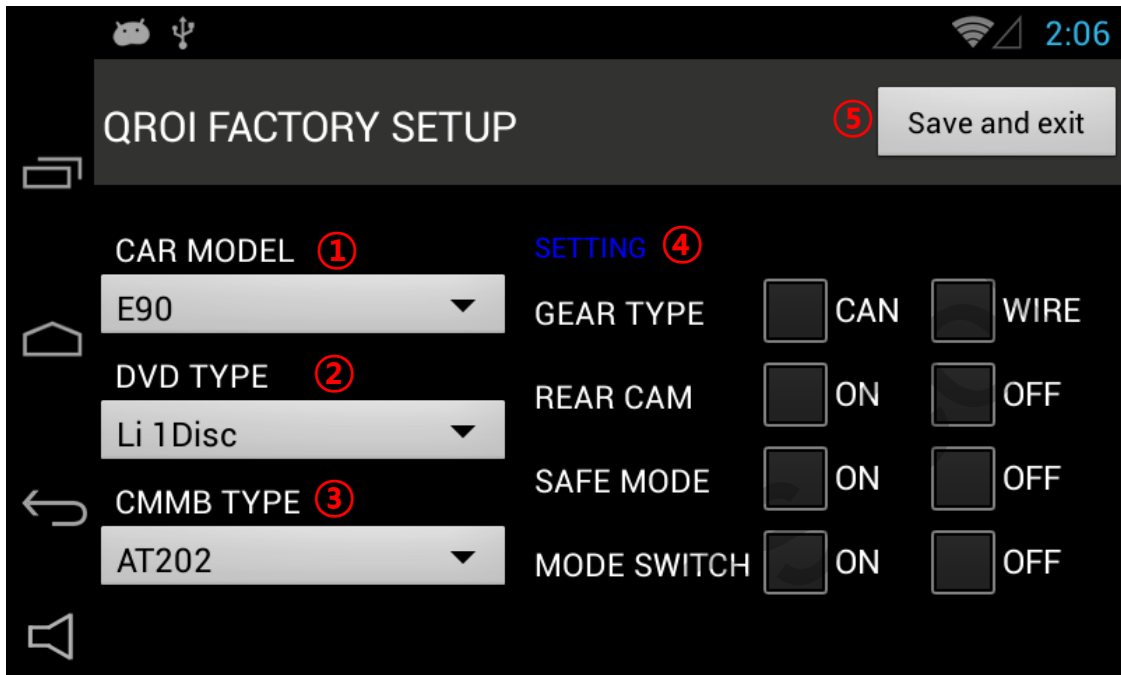

① CAR MODEL : No use

② DVD TYPE : Only for DVD connected to A/V

(Connect IR-AV1 to DVD to use DVD as touch Screen)

③ CMMB SELECT : Select DTV model (Only Chinese)

④ SETTING

- GEAR CHECK TYPE : Detecting rear camera via either CAN or Rear Lamp.

- REAR CAM : Put "On" – External rear camera

Put "Off " – OEM Camera

- SAFE MODE : Either Enable or Unable to watch Video while driving

- MODE SWITCH : NO use

⑤ SAVE & EXIT : Save and Reboot

6. Cautions before Installation

- Ignition key should be taken off before starting installation, interface power connection must be the last step in installation.
- Power cable should be separated when connecting interface.
- Should be no any electronic devices or magnetic pole around installation place.
- All steps of installation should be done by well-trained specialist.
- Dismantling without manufacturer's permission can not be guaranteed, (No permission to break attached label on the board.)
- Kindly check all parts are in the box, when receiving the product, if anything missing, inform to the supplier or manufacturer.
- Install GPS away from electromagnetic devices such as black boxes, Hi-Pass and etc.
- Advisable to Install GPS at the edge of dash board or a front window or a rear window.
- Install GPS antenna mounted on window or roof facing to Sky .
- According to our sales policy, any problems caused by user's mistake, careless can not be guaranteed.

7. Installation Diagram

- ※ 1. Remove Original LCD cable from Radio system and Connect it to Sub-Board "To monitor".
- 2. Connect Provided LCD cable to Behind of Radio system

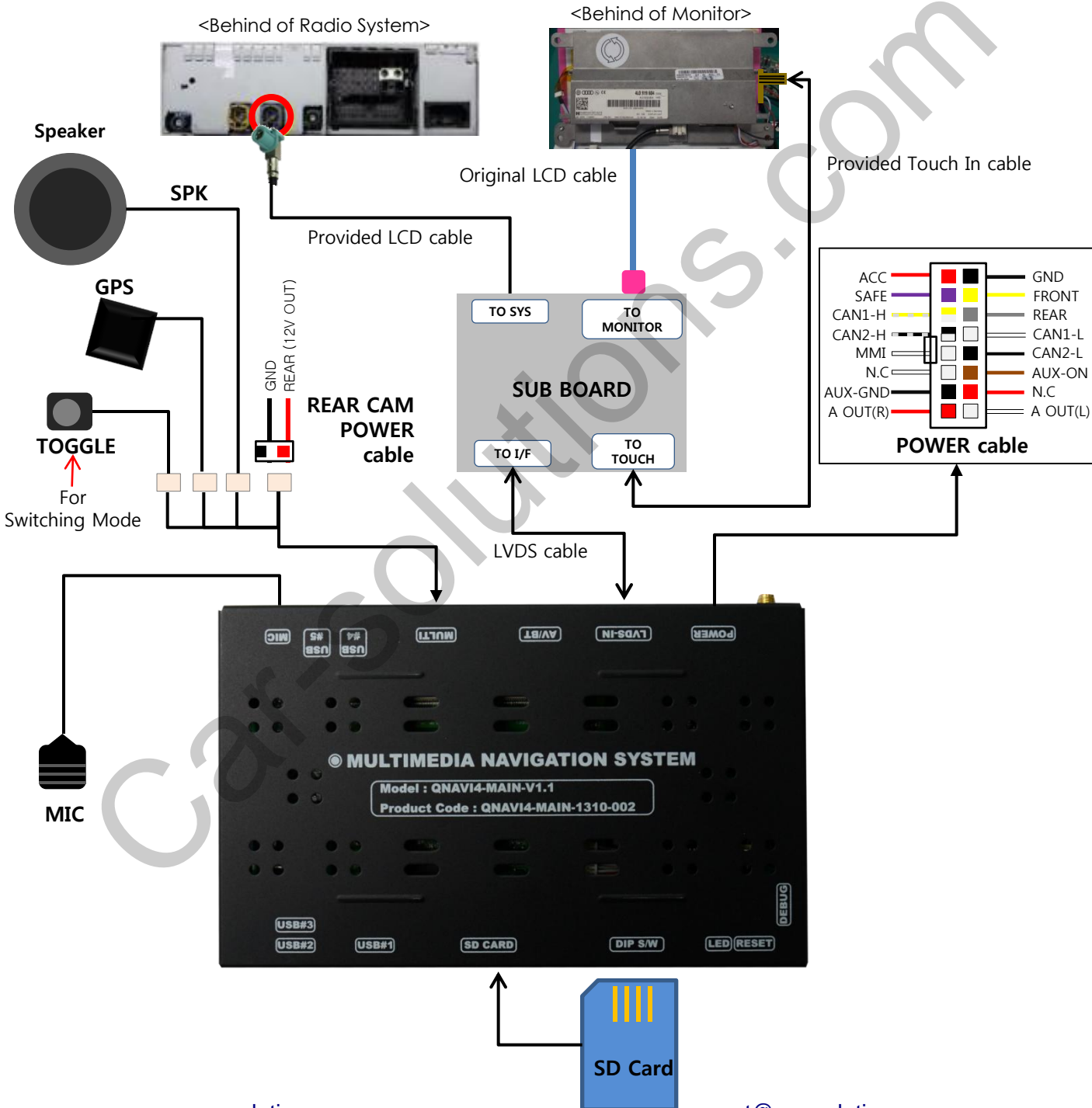

8. Installation

8.1 Connection of CAN Wire

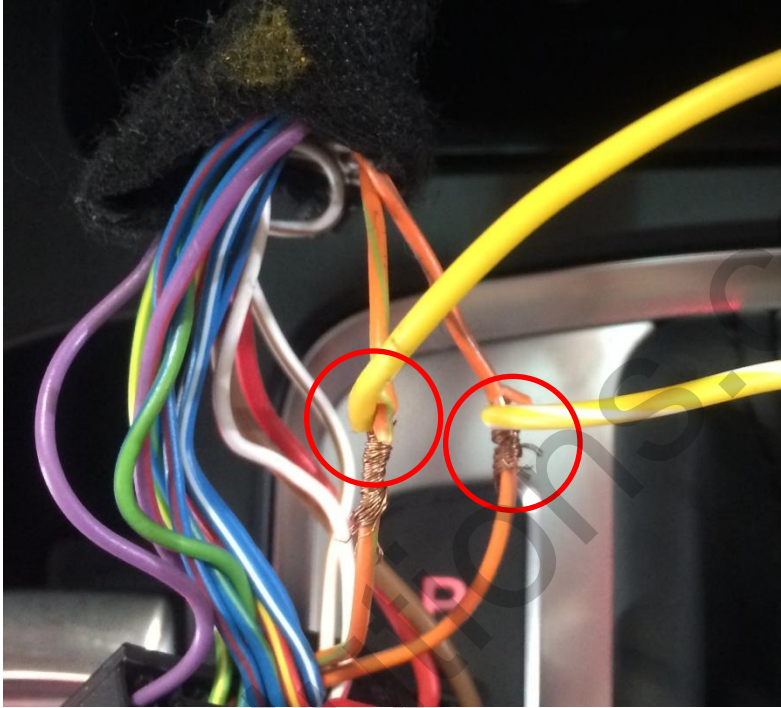

- * Connect CAN1-H(Yellow + White) of Provided Power cable to CAN-High(Brown + Orange) of Car.
- * Connect CAN1-L(Yellow) of Provided Power cable to CAN-Low(Green + Orange) of Car
- ※ You will be able to find the bunch of cable behind Radio System

8. Installation

8.2 Connection of LCD cable after dismantling a monitor

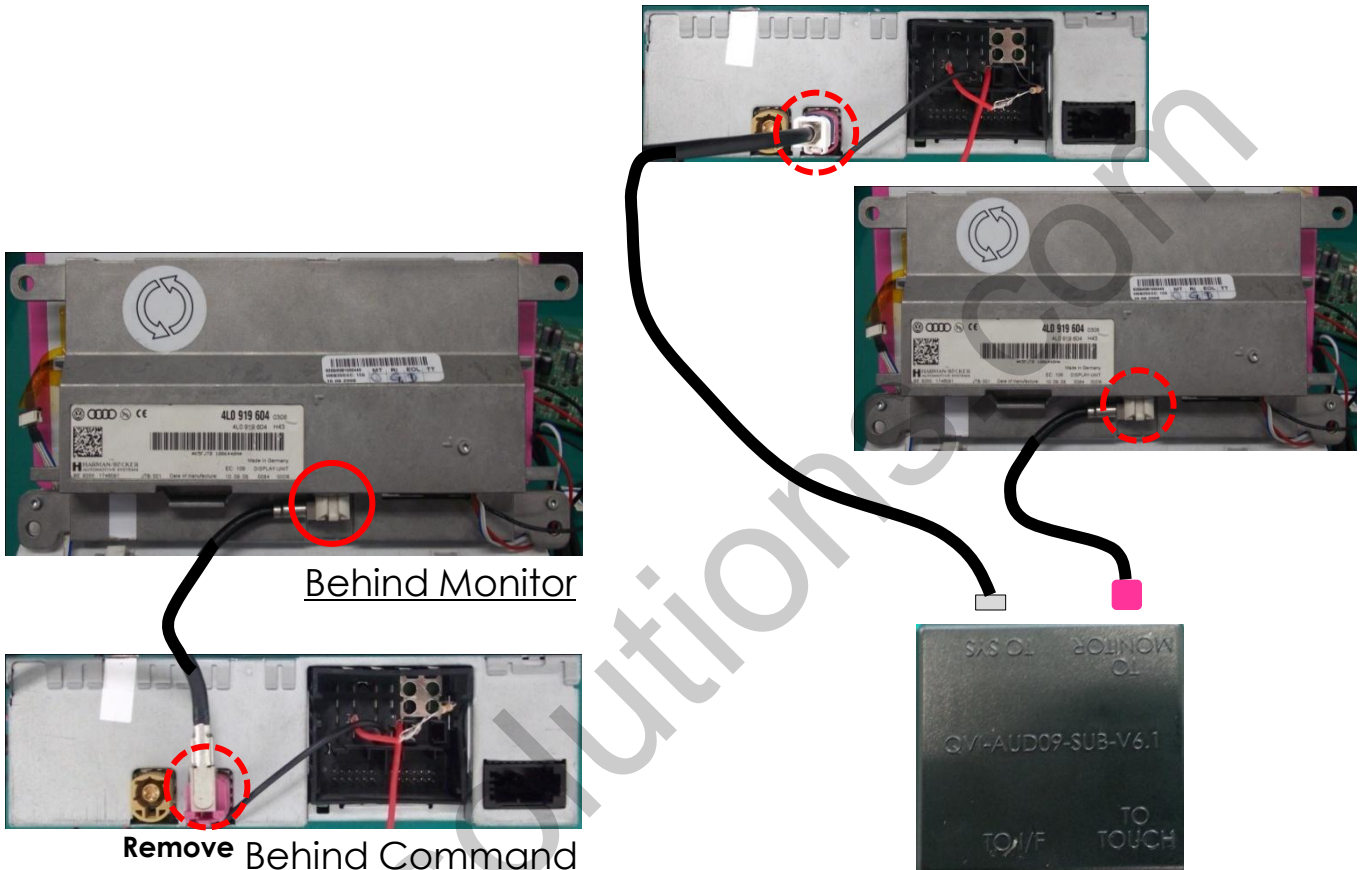

- ① Please refer to the photo (After dismantling a monitor and command).

You can see that the OEM cable connected to back side of the monitor has connected to back side of the Radio System.

- ② Remove OEM LCD cable from the Radio System and Connect to 'To monitor' of Sub-board.
- ③ Connect provided LCD cable to the ports where 'To SYS' of sub-board & OEM LCD cable of Radio System.

9. Quality Warranty

This product has been tested and have passed under our strict quality control. If the failure occurred due to the carelessness of workmanship within one year after the purchase, we are responsible to repair free of charge.

Please bring this warranty to dealer whom you purchased this product from at the repair time. Should this warranty not presented, repair charged will be on customer. Please keep this warranty card.

Warranty			
Product name	QROI		
Warranty period	1 year	Purchase date (yy/mm/dd)	
Customer	Address		
	TEL		
	Name		
Dealer	Address		
	Name		