

How to Make a LED Light Bulb

1

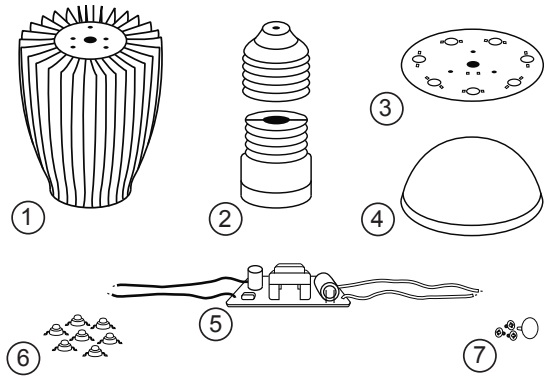

Package contents:

1) Light bulb housing. 2) Base. 3) PCB for LEDs. 4) Diffuser with a ring. 5) Power supply driver. 6) LEDs. 7) Screws.

2

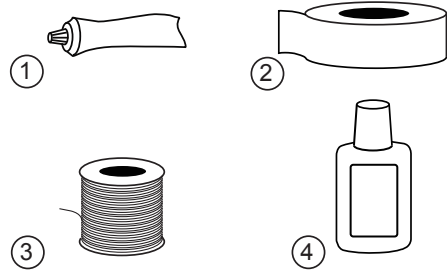

Consumables you'll need:

1) Thermal paste. 2) Thermal adhesive tape. 3) Solder. 4) Flux.

3

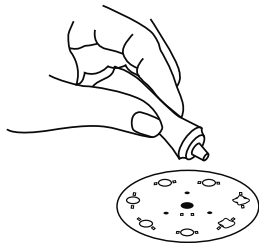

Apply the thermal paste to the LEDs installation locations on the PCB.

4

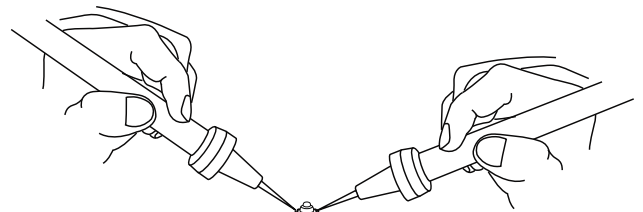

Determine polarity of the LEDs by the "-" sign on one of the leads (or using a multimeter).

5

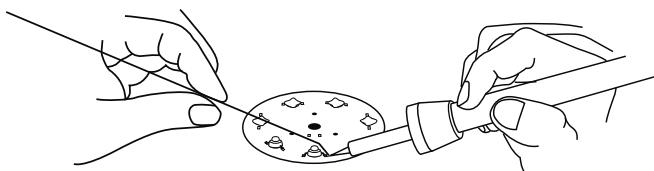

Place the LEDs on the PCB with the correct polarity and solder them to the PCB.

6

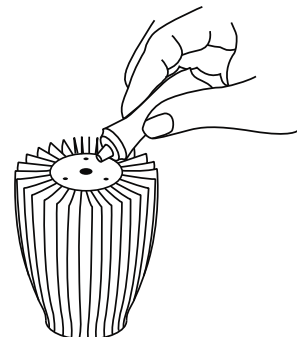

Apply the thermal paste at the point of contact of the PCB with the housing.

7

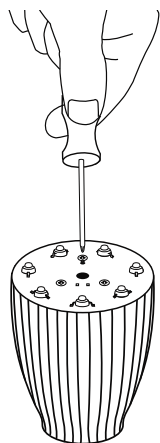

Screw the PCB to the housing.

8

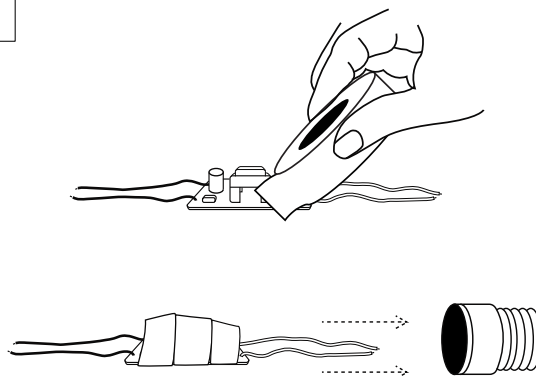

Roll up the power supply driver in thermal adhesive tape and place it in the base.

9

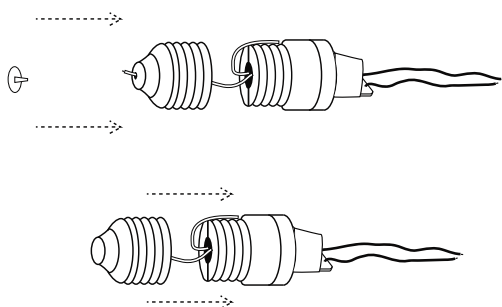

One of the white wires should go through the center of the base and must be fixed using the screw with a flat cap. The other wire must be fixed during the base assembly.

10

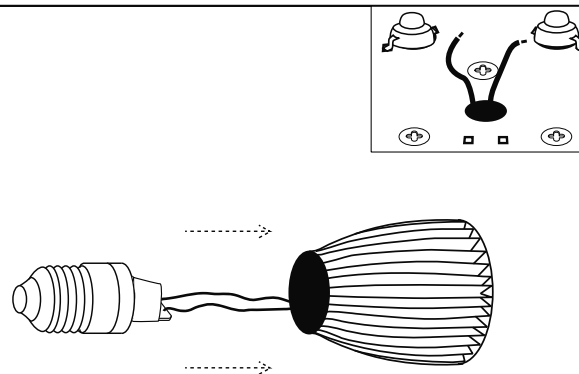

Screw the base to the housing so that the red and black wires go through a hole in the middle of the PCB with LEDs.

11

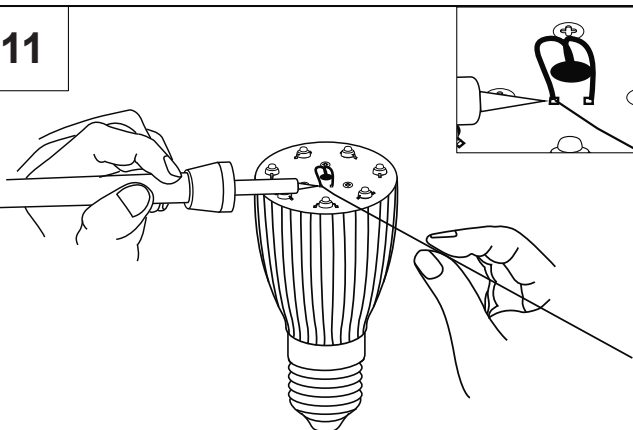

Solder the red wire to a positive contact point and black wire to a negative contact point on the PCB.

12

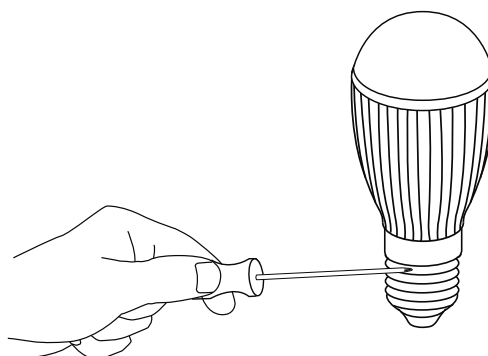

Screw on the light diffuser to the housing* and fix the base to the housing with a sharp tool in 4-6 points.

* For SQ-25 housing: first attach the metal ring from the diffuser to the housing (in order to separate the ring from the diffuser you'll need to pry it up using a screwdriver), screw the PCB with LEDs to the housing and insert the diffuser into the ring. If the PCB has some rough edges which prevent it from attaching properly to the housing, you'll need to cut them off with scissors.