

New

HIOKI 3246 PENCIL HiTESTER

Field measuring instruments



Penlight



Ultra Bright



Backlight LCD



ISO14001
JQA-E-90091



CE

Smart Design and Ease of use



Backlight LCD is highly visible, even in dark locations

Penlight brightly illuminates test points

◆ 600 V circuit protection makes fuses unnecessary

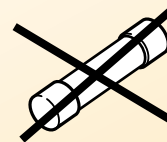

◆ Comes with protective probe tip cap

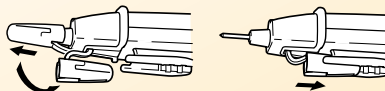

Actual-size

◆ Test lead fits neatly into back of instrument

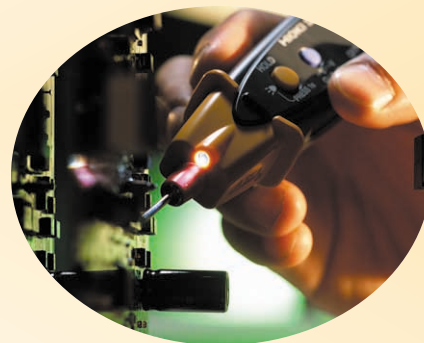
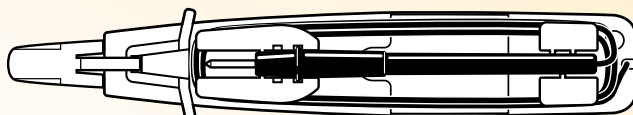

■ Specifications (Accuracy at 23°C ± 5°C (73°F ± 9°F), 80% rh or less)

Function	Range (Accuracy)
DC voltage	420.0 m / 4.200 / 42.00 / 420.0 / 600 V (± 1.3 %rdg. ± 4 dgt.)
AC voltage (50 to 500 Hz)	4.200 / 42.00 / 420.0 / 600 V (± 2.3 %rdg. ± 8 dgt.)
Resistance (open terminal voltage 3.4 V max.*1)	420.0 / 4.200 k / 42.00 k / 420.0k / 4.200 M / 42.00 MΩ (± 2.0 %rdg. ± 4 dgt.*2)
Continuity (open terminal voltage 3.4 V max.)	420.0 Ω (± 2.0 %rdg. ± 4 dgt.) Buzzer sounds at approx 50 Ω ± 30 Ω or less
Diode test (open terminal voltage 3.4 V max.)	Forward direction identification function*3 Indicator flashes and buzzer sounds to indicate forward direction

*1. at 420 Ω. (4.2 k 0.7 V (typ.) 42 k to 42 M 0.5 V (typ.))

*2. at 420 to 420 kΩ. (4.2 MΩ ± 5.0 %rdg. ± 4 dgt. 42 MΩ ± 10.0 %rdg. ± 4 dgt.)

*3. Works when diode has a forward voltage from 0.3 V to 2.0 V

● Measurement system: average value rectification ● Display: Max. 4199-count LCD ● Range switching: automatic or manual ● Ancillary functions: data hold function, auto power save function, battery life warning function, penlight, backlight LCD ● Sampling rate: 2.5 times/sec ● Overload protection: 600 Vrms (sin) or 3 × 10⁶ VHz for all functions ● Applicable standards: Safety - EN61010 CAT III 600V, EMC - EN61326 ● Ambient temperature of use: 0 to 40°C (32°F to 104°F), 80%rh (no condensation) ● Storage temperature range: -20 to 60°C (-4°F to 140°F), (no condensation) ● Power source: CR2032 battery × 1 (3V DC) ● Continuous operating time: approx. 150 h (During DC voltage measurement), approx. 30 h (During DC voltage measurement, assuming 10 sec illumination alternating with 20 sec dark) ● Dimensions and mass: Approx. 30 W × 182 H × 26.5 D mm, 80 g (Approx 1.2" (W) × 7.2" (H) × 1.0" (D), 2.8 oz.)

3246 PENCIL HiTESTER

Option

9081 10 A SHUNT (output: 100 mV / 10 A)

HIOKI

HIOKI E. E. CORPORATION